

HAKKO 913 SOLDERING IRON 914

Soldering Iron with Built-in Smoke Absorption Pipe

Instruction Manual

●

Thank you for purchasing the HAKKO 913/914 Soldering Iron.
Please read this manual before operating the HAKKO 913/914.
Store the manual in a safe, easily accessible place for future
reference.

●

Table of Contents

Part Names • Specifications	
Applicable Models • Setting Up	1
Operating Instructions	
Maintenance • Parts List	2

Part Names

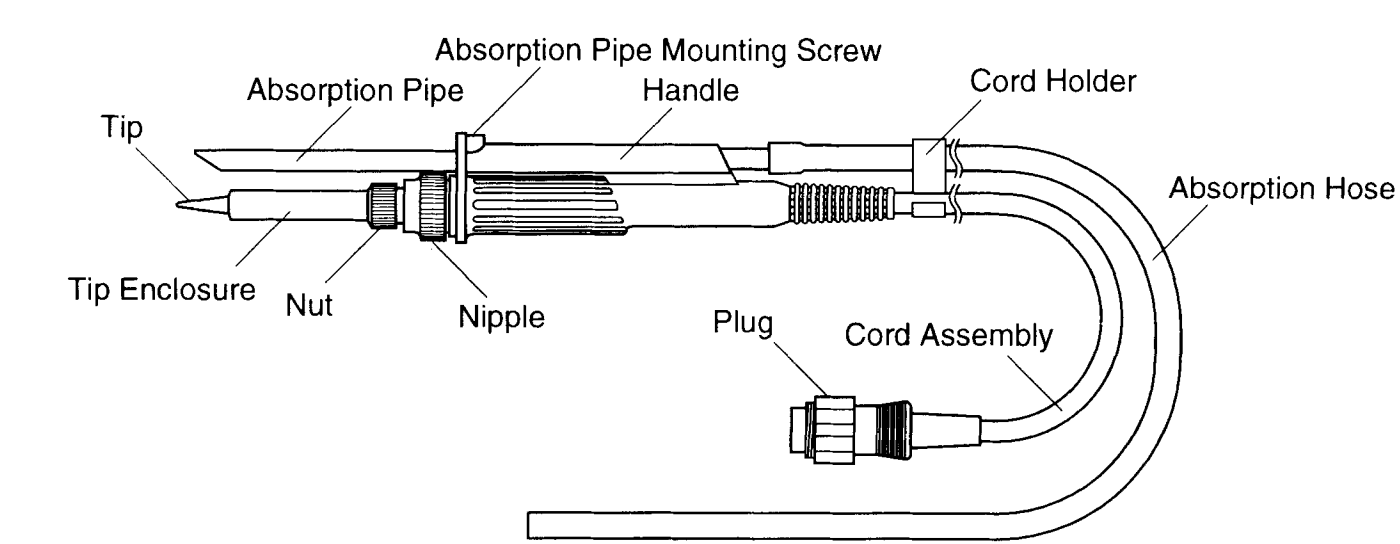

Specifications

	913	914
Power Consumption	24V 50W	
Tip to Ground Resistance	Under 2Ω	
Tip to Ground Potential	Under 2mV	
Heating Element	Ceramic heater	
Hose Diameter & Length	φ 5mm x φ 8mm x 2m (φ 0.20in. x φ 0.31in. x 6.6ft.)	
Cord Length (w/o Hose and Cord)	1.2m (4ft.)	
Total Length (w/o Hose and Cord)	190mm (7.48in.)	200mm (7.87in.)
Weight (w/o Hose and Cord)	57g (0.13lbs.)	67g (0.15lbs.)

Applicable Models

HAKKO 913/914 cannot be used individually. Use in combination with equipment selected from the table below.

Soldering Station	Soldering Iron	Tip	Smoke Absorber
HAKKO 926 HAKKO 927 HAKKO 928 HAKKO 700C	HAKKO 913	900M Series	HAKKO 490 HAKKO 494 etc.
HAKKO 936 HAKKO 937 HAKKO 701	HAKKO 914	900L Series	

- * The iron holder of HAKKO 926, 927, 928 or 700C made for the 900M (ESD) or 900L (ESD) cannot be used. The optional iron holder (No. C1142) is available.
- * HAKKO 913 consists of a No. 900M-ESD or 907-ESD equivalent soldering iron and a built-in smoke absorption pipe. HAKKO 914 consists of a No. 900L-ESD or 908-ESD equivalent soldering iron and a built-in smoke absorption pipe.

Setting Up

1. Connections

2. Calibration

3. Adjusting the Absorption Pipe

- Connect the absorption hose to the smoke absorber and the plug to the soldering station.
- Before using the soldering station for the first time, calibrate the tip temperature as described in the instruction manual of the soldering station.
- ⚠ **CAUTION:** The tip temperature drops slightly when the smoke absorber is in use. In workplaces where strict temperature control is required, measure the tip temperature (using the HAKKO 191 Thermometer or 192 Soldering Tester) ten (10) minutes after operating the smoke absorber.
- Adjust the position of the absorption pipe by sliding it back and forth to find an appropriate position.

Operating Instructions

- Operation is the same as the other soldering irons you have used except for smoke absorption function. For instructions, see the instruction manual for soldering station.

Maintenance

When soldering flux becomes clogged in the absorption hose and pipe of the iron, the suction strength is reduced. Clean the flux out of the hose and pipe on a regular basis.

⚠ CAUTION:

Do not use paint thinner or the like on the hose or pipe. Otherwise corrosion may result.

- Remove the absorption hose and loosen the set screw of the absorption pipe. Remove the absorption pipe.

Absorption pipe (stainless steel) Clean with flux cleaner or alcohol.

Absorption hose Clean by rubbing off the flux.

Parts List

Item No.	Part No.	Part Name	Description	For
1	B1784	Nut		913
	B1794	Nut		914
2	B1786	Tip Enclosure		913
	B1787	Tip Enclosure		914
3		Tip	900M Series	913
		Tip	900L Series	914
4	B2022	Nipple		913
	B2033	Nipple		914
5	B2032	Grounding Spring		913, 914
6	A1321	Heating Element		913, 914
7	B2028	Terminal Board		913, 914
8	B2258	Handle	ESD	913
	B2259	Handle	ESD	914
9	B2031	Cord Bushing		913, 914
10	B2030	Cord Assembly	ESD	913, 914
11	B2260	Absorption Pipe L*		913, 914
12	B2262	Cord Holder	Set of 5	913, 914
13	B2263	Absorption Hose/2m (6.6ft.)	ESD	913, 914

Option

14	B2261	Absorption Pipe S**		913, 914
	B2264	Absorption Hose/10m(33ft.)	ESD	913, 914
	B2265	Absorption Hose/50m(164ft.)	ESD	913, 914
	C1142	Iron Holder		913, 914

* Inside & Outside Diameter of Absorption Pipe L $\phi 5.8 \times \phi 6.35\text{mm}$ ($\phi 0.23 \times \phi 0.25\text{in.}$)

** Inside & Outside Diameter of Absorption Pipe S (pipe head) $\phi 3.45 \times \phi 4\text{mm}$ ($\phi 0.14 \times \phi 0.16\text{in.}$)

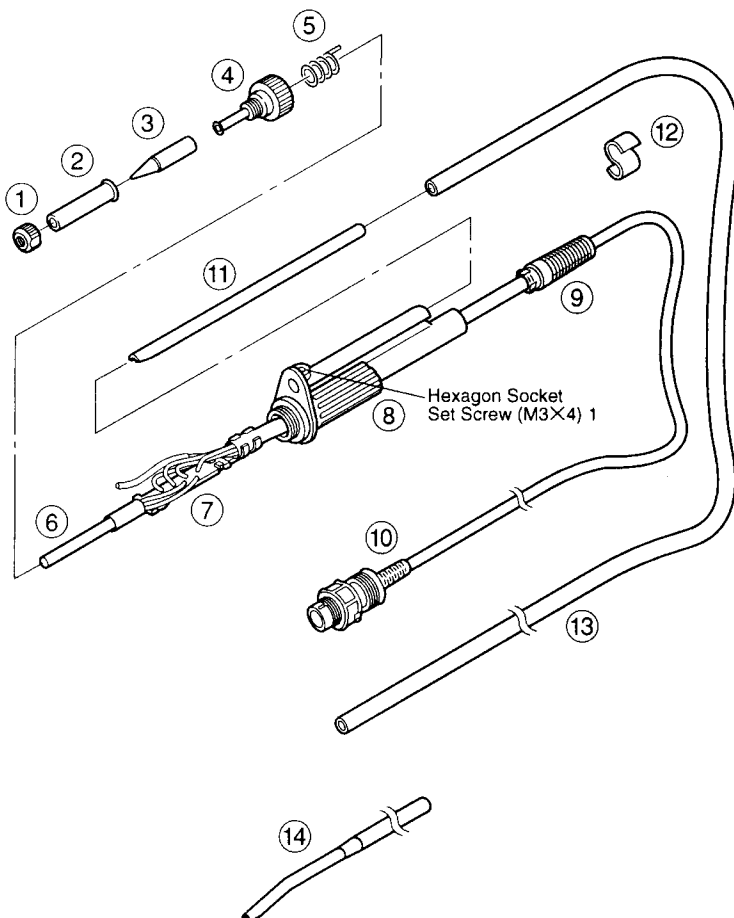



HEAD OFFICE

4-5, SHIOKUSA 2-CHOME, NANIWA-KU, OSAKA, 556 JAPAN
TEL: (06) 561-3225 FAX: (06) 561-8466
TLX: HAKKOOSA J65274

OVERSEAS AFFILIATES

U.S.A.: AMERICAN HAKKO PRODUCTS, INC.
25072 ANZA DR. SANTA CLARITA, CA 91355, U.S.A.
TEL: (805) 294-0090 FAX: (805) 294-0096
Toll Free (800)88-HAKKO
4 2 5 5 6

S'PORE: HAKKO PRODUCTS PTE., LTD.
1, GENTING LINK #02-04, PERFECT INDUSTRIAL
BUILDING, SINGAPORE 349518
TEL: 7482277 FAX: 7440033

HONG KONG: HAKKO DEVELOPMENT CO., LTD.
ROOM 804 EASTERN HARBOUR CENTRE,
28 HOI CHAK STREET, QUARRY BAY, HONG KONG.
TEL: 2811-5588 FAX: 2590-0217

PHILIPPINES: HAKKO PHILS TRADING CO., INC.
NO. 415 WINDSOR TOWER CONDOMINIUM,
163 LEGASPI ST., LEGASPI VILLAGE MAKATI,
METRO MANILA, PHILIPPINES
TEL: 2-810-07-12 FAX: 2-810-76-49

MALAYSIA: HAKKO PRODUCTS SDN BHD
MALAYSIA HEAD OFFICE: PETALING JAYA
LOT 35/1 THE HIGHWAY CENTRE JALAN 51/205 46050
PETALING JAYA WEST MALAYSIA
TEL: 03-7941333 FAX: 03-7911232

PENANG BRANCH: TEL: 04-644 6669 FAX: 04-644 8628
JOHORE BAHRU BRANCH: TEL: 07-236 7766 FAX: 07-237 4655